

NO	TYPE	X	Y	OBSERVATIONS
2002	BORNE	284299.514	119145.627	
2003	BORNE	284281.069	119174.745	
2004	BORNE	284274.612	119203.788	
2005	BORNE	284266.258	119206.590	
2006	BORNE	284240.648	119195.225	
2007	BORNE	284231.707	119169.862	
2008	BORNE	284212.483	119165.885	
2009	BORNE	284185.181	119168.862	
2010	BORNE	284165.889	119146.547	
2011	BORNE	284149.901	119144.358	
2012	BORNE	284137.328	119169.228	
2013	BORNE	284141.580	119161.898	
2014	BORNE	284138.923	119156.091	
2015	BORNE	284130.588	119130.572	
2016	BORNE	284125.916	119125.443	
2017	BORNE	284133.968	119070.203	
2018	BORNE	284087.930	119067.930	
2019	BORNE	284069.227	119076.410	
2020	BORNE	284069.030	119067.169	
2021	BORNE	284053.163	119053.556	
2022	BORNE	284024.705	119055.949	
2023	BORNE	283965.509	119070.483	
2024	BORNE	283956.117	119058.919	
2025	BORNE	283961.630	119028.331	
2026	BORNE	283949.229	119009.151	

NO	TYPE	X	Y	OBSERVATIONS
2027	PIQUET	283953.355	118996.765	
2028	PIQUET	283950.387	118986.357	
2029	PIQUET	283926.847	118977.118	
2030	PIQUET	283904.383	118983.122	
2031	PIQUET	283910.459	118911.210	
2032	PIQUET	283875.545	118894.167	
2033	PIQUET	283868.106	118881.524	
2034	PIQUET	283876.056	118860.965	
2035	PIQUET	283849.445	118871.818	
2036	PIQUET	283904.784	118845.402	
2037	PIQUET	283920.351	118778.000	
2038	PIQUET	283925.989	118768.311	
2039	PIQUET	283931.887	118740.522	
2040	PIQUET	283933.791	118714.955	
2041	PIQUET	283965.704	118716.524	
2042	PIQUET	283967.842	118706.136	
2043	PIQUET	283964.511	118704.171	
2044	PIQUET	283978.840	118721.846	
2045	PIQUET	283961.926	118732.823	
2046	PIQUET	283989.995	118737.454	
2047	PIQUET	283997.463	118728.034	
2048	PIQUET	284011.793	118731.097	
2049	PIQUET	284021.317	118728.042	
2050	PIQUET	284030.171	118736.753	
2051	BORNE	284036.883	118749.566	

REPERES SEMAPHORE
15m croix gravée au centre torse
X : 284071.31
Y : 119033.78

nature	N°	X	Y	distances
PIQUET	1	284299.514	119145.627	34.468
PIQUET	2	284281.069	119174.745	29.752
PIQUET	3	284274.612	119203.788	8.811
PIQUET	4	284266.258	119206.590	28.018
PIQUET	5	284240.648	119195.225	26.798
ROCHER	6	284231.707	119169.862	19.652
PIQUET	7	284212.483	119165.885	77.464
PIQUET	8	284185.181	119168.862	29.498
ROCHER	9	284165.889	119146.547	16.137
PIQUET	10	284149.901	119144.358	27.917
PIQUET	11	284137.328	119169.228	8.324
PIQUET	11*	284141.580	119161.898	18.503
ROCHER	12	284130.588	119130.572	15.625
ROCHER	13	284125.916	119125.443	56.147
PIQUET	14	284133.968	119070.203	46.538
ROCHER	15	284087.930	119067.930	20.132
ROCHER	16	284069.227	119076.410	9.243
ROCHER	17	284069.030	119067.169	20.907
PIQUET	18	284053.163	119053.556	28.557
ROCHER	19	284024.705	119055.949	40.870
ROCHER	20	283965.509	119070.483	32.526
ROCHER	21	283956.117	119058.919	31.126
PIQUET	22	283961.630	119028.331	22.977
ROCHER	23	283949.229	119009.151	

nature	N°	X	Y	distances
ROCHER	24	283953.355	118996.765	12.568
ROCHER	25	283950.387	118986.357	23.438
ROCHER	26	283926.847	118977.118	25.390
ROCHER	27	283904.383	118983.122	72.168
ROCHER	28	283910.459	118911.210	38.852
ROCHER	29	283875.545	118894.167	14.669
ROCHER	30	283868.106	118881.524	8.568
ROCHER	31	283876.056	118860.965	5.720
ROCHER	32	283849.445	118871.818	30.547
ROCHER	33	283904.784	118845.402	69.116
ROCHER	34	283920.351	118778.000	11.216
ROCHER	35	283925.989	118768.311	28.406
ROCHER	36	283931.887	118740.522	33.662
ROCHER	37	283933.791	118714.955	12.023
ROCHER	38	283965.704	118716.524	10.606
ROCHER	39	283967.842	118706.136	3.868
ROCHER	40	283964.511	118704.171	22.754
ROCHER	41	283978.840	118721.846	11.403
ROCHER	42	283961.926	118732.823	9.303
ROCHER	43	283989.995	118737.454	12.021
ROCHER	44	283997.463	118728.034	14.655
ROCHER	45	284011.793	118731.097	40.604
ROCHER	46	284021.317	118728.042	12.421
ROCHER	47	284030.171	118736.753	15.485
ROCHER	48	284036.883	118749.566	97.643
ROCHER	49	284131.320	118764.991	

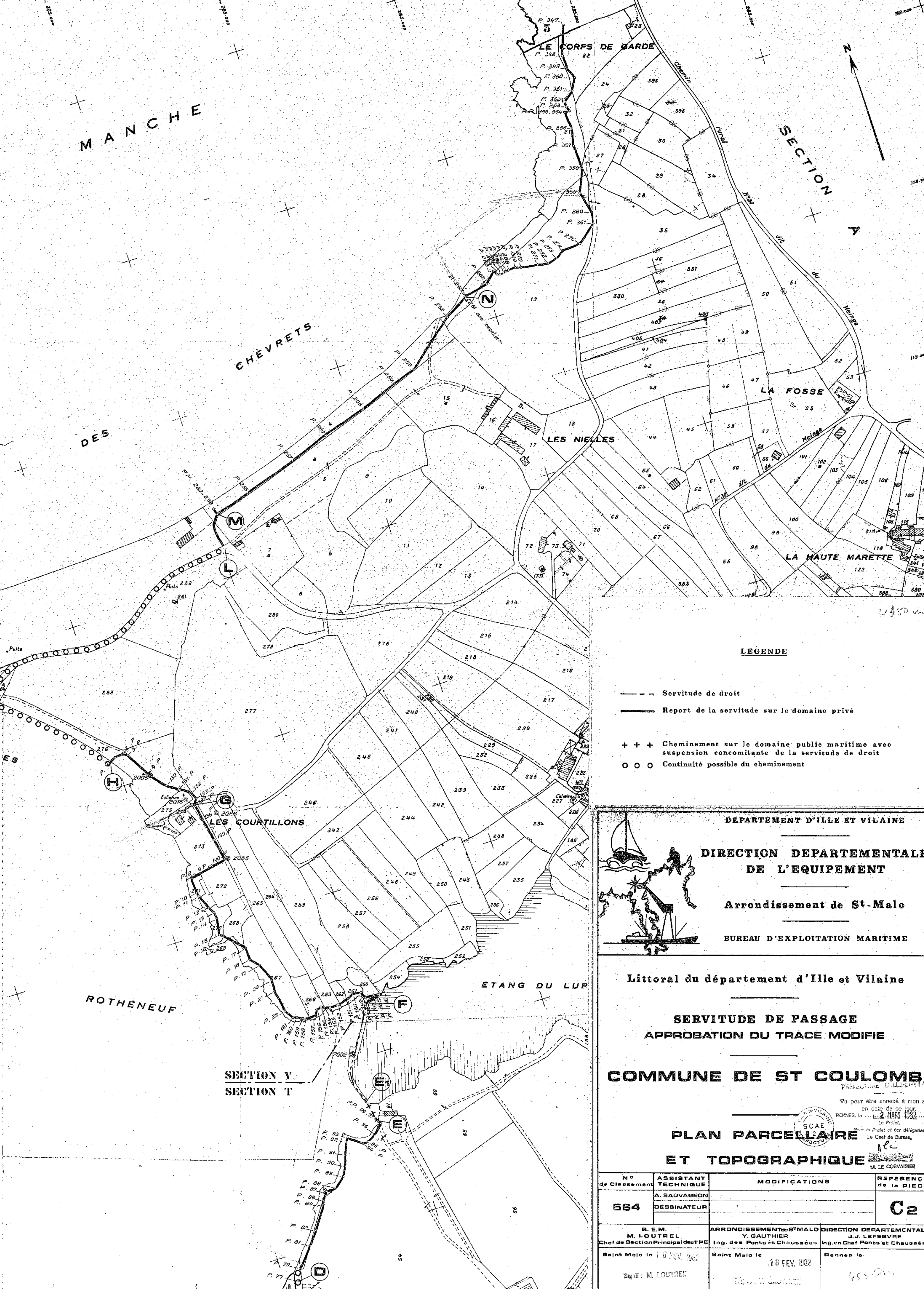
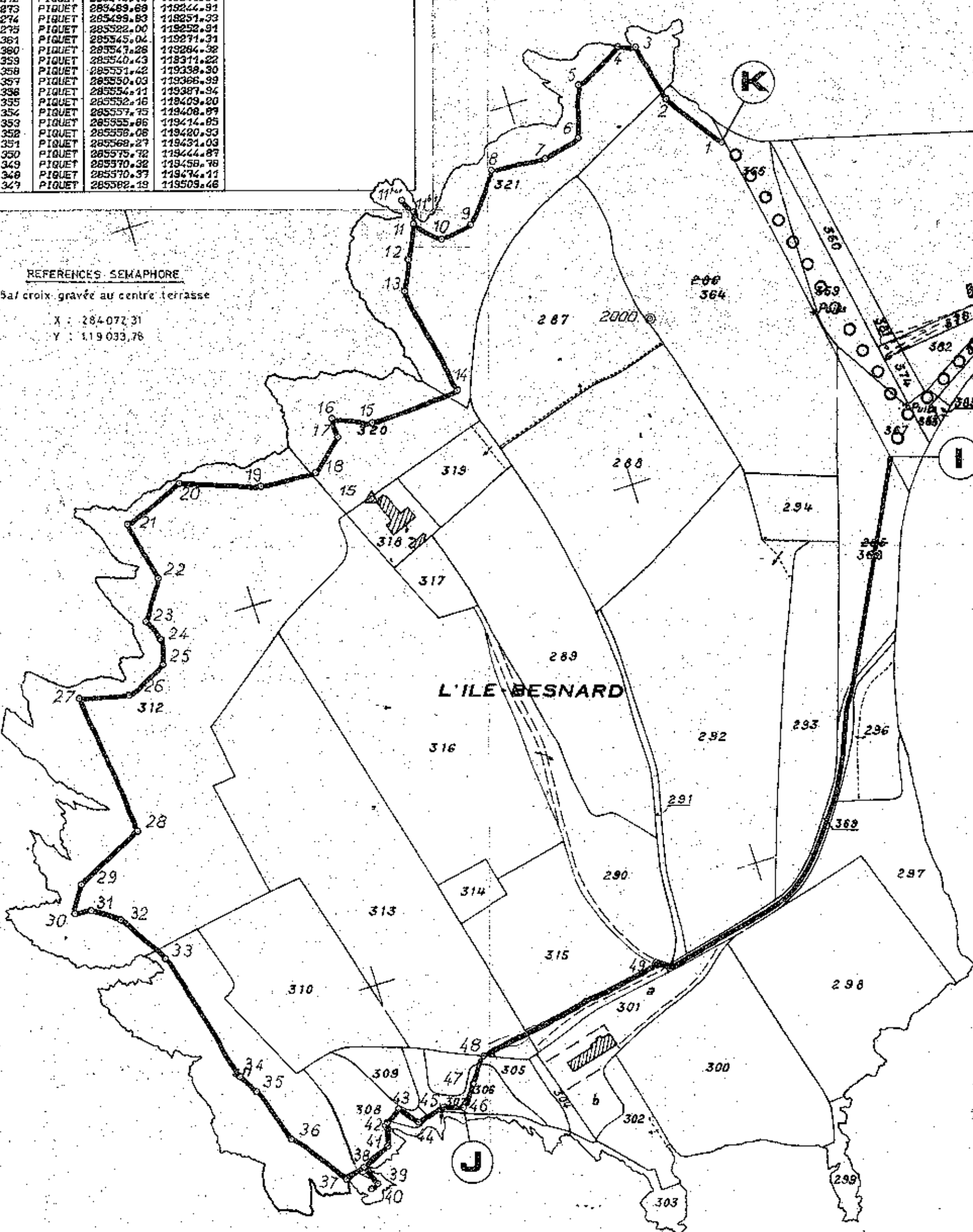

LEGENDE

- Servitude de droit
- Report de la servitude sur le domaine privé
- +++ Cheminement sur le domaine public maritime avec suspension concomitante de la servitude de droit
- ooo Continuité possible du cheminement

DEPARTEMENT D'ILLE ET VILAINE
DIRECTION DEPARTEMENTALE DE L'EQUIPEMENT
Arrondissement de St-Malo
BUREAU D'EXPLOITATION MARITIME

Littoral du département d'Ille et Vilaine

SERVITUDE DE PASSAGE
APPROBATION DU TRACE MODIFIE

COMMUNE DE ST COULOMB

PLAN PARCELLAIRE ET TOPOGRAPHIQUE

N° de Classement	ASSISTANT TECHNIQUE	MODIFICATIONS	REFERENCE de la PIECE
564	A. SALVAGEON DESSINATEUR		C2
M. LOUTREL Ing. en Chef des Ponts et Chaussées		ARRONDISSEMENT DE ST-MALO J. C. GAUTHIER Ing. en Chef Ponts et Chaussées	DIRECTION DEPARTEMENTALE
Saint-Malo le 18 FEV. 1962		Saint-Malo le 18 FEV. 1962	Rennes le
Signé : M. LOUTREL			